



Custom Fields Default Values

Shopware 6 Extension

Instalation + Configuration

1. Install and activate Custom Fields Default Values extension

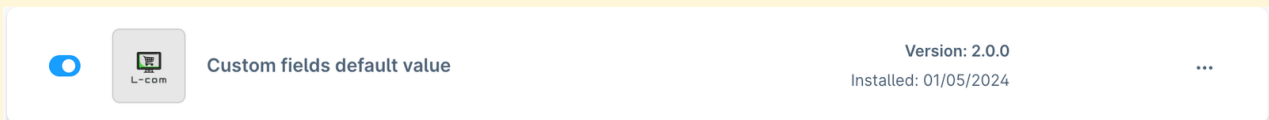

That's it from installation process.

Usage

To assign default value to entity navigate to **Settings -> Custom Fields -> your custom field set**. If you don't have custom field set, you have to create one. When you have existing custom fields set, you can start adding custom fields.

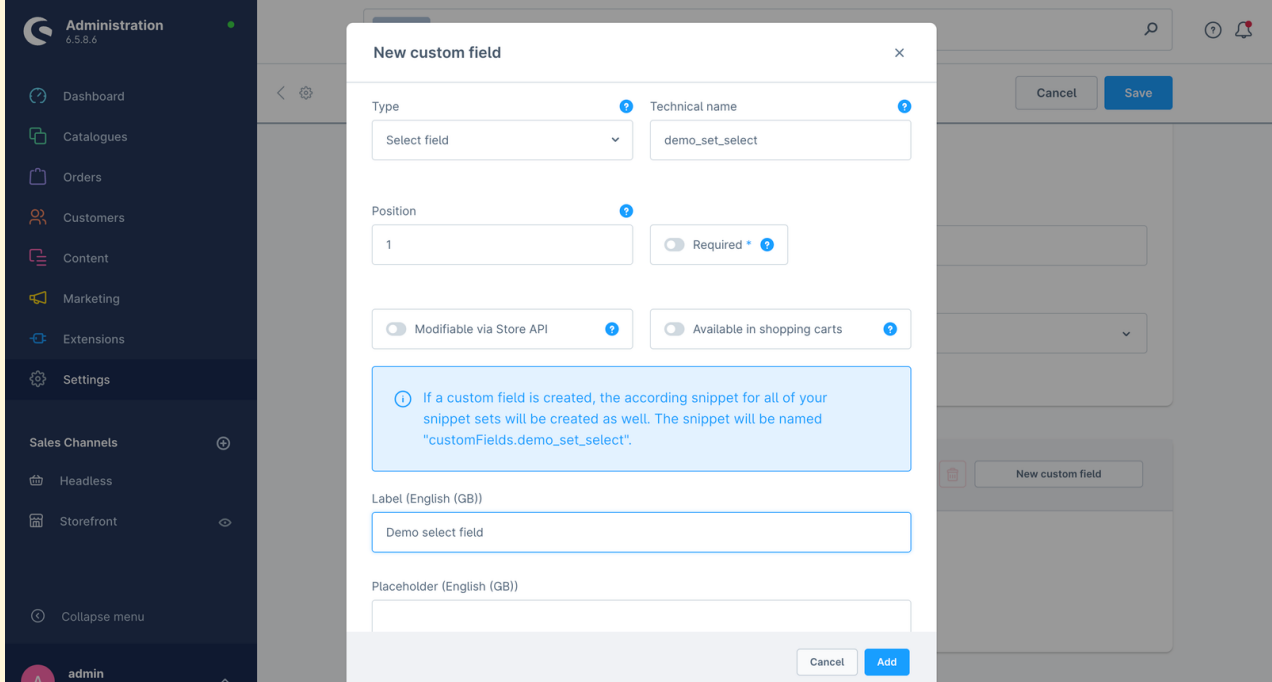

Assignment of default value can be done after custom field was created, in edit mode. So to assign default value to our custom field click edit button, scroll down to the bottom of page, and you will see a different component depending on custom field type. In our example it is a single select component. Now assign default value and save changes.

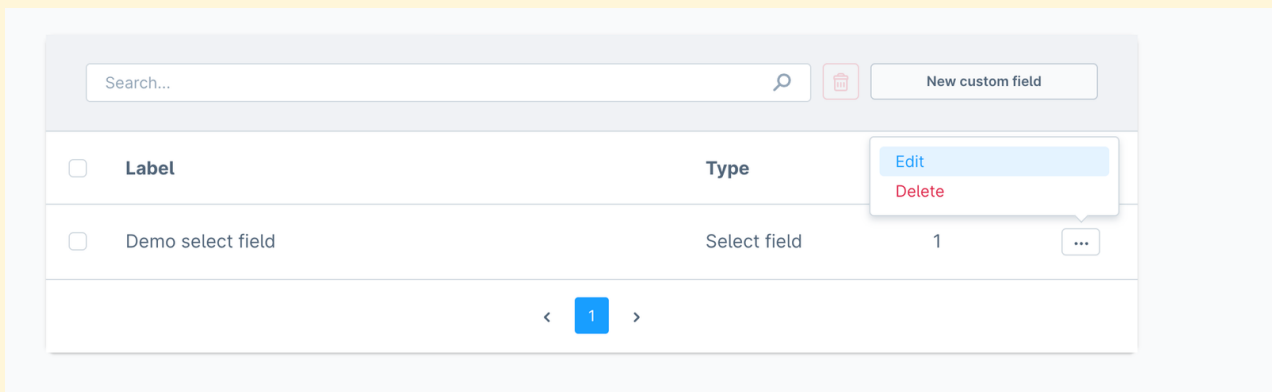

Option 2:

Delete

Technical name

value_2

Label (English (GB))

option 2

Add option

Default Value

option 2

Cancel

Apply changes

In our case custom field set is assigned to category, so after creating new category we can see that default value is assigned to custom field.

Custom fields

Demo Set

Demo select field

option 2

single select \ multi select

In custom fields of select type, option to change select type after creation was disabled to avoid complexity and potential problems when data was already populated.



L-com